

BATTERIA SIGILLATA AGM CON ELEVATO SPUNTO DI AVVIAMENTO
 AGM MAINTENANCE FREE BATTERY WITH HIGH CRANKING RATE

ZPC120020



CHARACTERISTIC / CARATTERISTICHE

Volt	12V	
Capacity / Capacità	20h	20 Ah
Reserve capacity at 25A / Riserva di capacità a 25A	28 min.	
Positive / Positivo	dx	
Short circuit current / corrente costo circuito	800Amp	
EN Cranking features / Prestazioni avviamento EN	PHCA 5sce. 27°C	680Amp
	CCA	230Amp
	CA	310Amp
	HCA 27°C	410Amp
Self-Discharge 25°C Capacity / Autoscarica a 25°C	after 3 month storage	90%
	after 6 month storage	80%
	after 12 month storage	62%
Charge (constant voltage) 25°C	Float	13.6 - 13.8 Volt
	Charge	Max. 6.0Amp. 14.4 - 14.8 Volt

CHARACTERISTIC / CARATTERISTICHE

Battery dimensions / Dimensioni batteria			
L/L	W/P	H/A	Tot - H/A
181	77	158	167
Weight / Peso			5.75 Kg
Terminal / Terminali			M5
Plt Qt / Qt per pallet			144
Case / Contenitore			ABS

HIGH RATE DISCHARGE "EN" CORRENTE DI SPUNTO, "EN" (25°C)

5 sec.	10 sec.	15 sec.	20 sec.
680A	595A	515A	400A

EXTENDED DISCHARGE (25°C) TO 10.02V CORRENTE DI SCARICA FINO A 10.2VOLT (25°C)

5 min	15 min	1 hr	3 hr	5 hr	10 hr	20 hr
82A	38A	13.2A	5.1A	3.4A	1.9A	1A

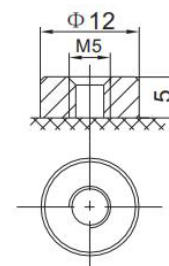
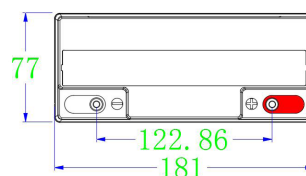
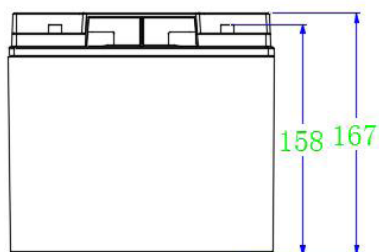

This information is generally descriptive only and is not intended to make or imply any representation, guarantee or warranty with respect to any cells and batteries. Cell and battery designs/specifications are subject to modification without notice. Contact U.B.S. UNION BATTERY SERVICE for the latest information.

Le informazioni contenute in questa scheda tecnica sono solo descrittive e indicative, non sono una garanzia. U.B.S. UNION BATTERY SERVICE si riserva il diritto di aggiornarle/modificarle senza preavviso.



www.unionbatteryservice.it